



# 常规系列 (General purpose) DJW12-35(12V35Ah)



## 规格 Specifications

额定电压 Rated Voltage	12V	
标称容量 Nominal Capacity(C <sub>20</sub> , 1.80V/cell)	35Ah	
尺寸 Dimension	长 Length	195±2mm (7.68 in.)
	宽 Width	130±2mm (5.12 in.)
	高 Container Height	164±2mm (6.46 in.)
	总高(含端子) Total Height	170±2mm (6.69 in.)
重量 Approx Weight	10.2 Kg (22.5 lbs)	
端子 Terminal	M6	
外壳材料 Container Material	ABS	
额定容量 Rated Capacity (25°C)	35.00 Ah	C20(1.75A, 1.80V/cell)
	32.60 Ah	C10(3.26A, 1.80V/cell)
	30.10 Ah	C5(6.02A, 1.75V/cell)
	27.63 Ah	C3(9.21A, 1.75V/cell)
	22.50 Ah	C1(22.5A, 1.67V/cell)
5S最大放电电流 Max. Discharge Current	525A (5s)	
内阻 Internal Resistance (25°C)	Approx 13.0mΩ	
运行温度 Operating Temp.Range	放电 Discharge	-20 ~ 55°C (-4 ~ 131°F)
	充电 Charge	0 ~ 40°C (32 ~ 104°F)
	存储 Storage	-15 ~ 50°C (5 ~ 122°F)
推荐温度 Nominal Operating Temp. Range	25±5°C (77±5°F)	
最大充电电流(25°C)Max.Charging Current	10.5A	
充电电压(25°C) Charge voltage	浮充 Float	13.5~13.8V
	温度补偿 Temp. Coefficient	-3mV/单格/°C
	循环(均充) Cycle(Equalization)	14.1~14.4V
温度对容量影响 Effect of temp. to Capacity	40°C (104°F)	106%
	25°C (77°F)	100%
	0°C (32°F)	86%
自放电 Self Discharge	≤3%/月 @ 25°C	



## 外形 Layout

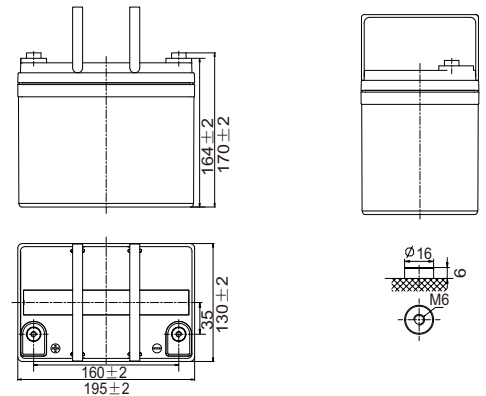

## 恒流放电表(A) 25 °C Constant Current Discharge

F.V/Time	5min	10min	15min	20min	30min	45min	1h	1.5h	2h	3h	4h	5h	6h	8h	10h	20h
1.85V/cell	87.9	60.6	48.0	39.2	29.5	21.9	18.5	13.8	11.1	8.29	6.56	5.46	4.70	3.73	3.05	1.66
1.80V/cell	102.4	71.5	55.8	45.2	33.3	24.4	20.5	15.1	12.0	8.97	7.07	5.89	5.04	3.99	3.26	1.75
1.75V/cell	111.8	76.7	59.0	47.4	34.8	25.4	21.2	15.6	12.4	9.21	7.25	6.02	5.15	4.06	3.31	1.77
1.70V/cell	121.0	81.8	62.4	49.9	36.4	26.4	22.0	16.2	12.8	9.47	7.43	6.16	5.26	4.13	3.36	1.79
1.67V/cell	126.4	84.7	64.3	51.3	37.3	27.0	22.5	16.5	13.0	9.62	7.53	6.23	5.32	4.18	3.39	1.81
1.60V/cell	139.3	91.7	69.0	54.6	39.4	28.4	23.6	17.2	13.6	9.97	7.78	6.42	5.47	4.28	3.46	1.84

## 恒功率放电表(W) 25 °C Constant Power Discharge

F.V/Time	5min	10min	15min	20min	30min	45min	1h	1.5h	2h	3h	4h	5h	6h	8h	10h	20h
1.85V/cell	167.4	116.1	92.2	75.5	57.0	42.4	36.0	27.0	21.6	16.2	12.9	10.8	9.26	7.36	6.04	3.30
1.80V/cell	192.6	135.4	106.1	86.2	63.9	47.0	39.5	29.3	23.4	17.5	13.8	11.6	9.91	7.87	6.43	3.48
1.75V/cell	207.5	143.6	111.1	89.6	66.2	48.6	40.7	30.1	24.0	17.9	14.1	11.8	10.1	8.00	6.52	3.52
1.70V/cell	221.7	151.3	116.2	93.3	68.5	50.0	41.9	31.0	24.6	18.3	14.4	12.0	10.3	8.12	6.61	3.56
1.67V/cell	229.5	155.8	120.0	95.4	69.9	50.9	42.6	31.4	25.0	18.6	14.6	12.1	10.4	8.19	6.66	3.58
1.60V/cell	250.0	166.7	125.7	100.2	72.9	53.0	44.2	32.5	25.8	19.1	15.0	12.5	10.6	8.36	6.79	3.64



# 常规系列 (General purpose) DJW12-35(12V35Ah)



## 应用 Applications

- 通讯  
Telecommunications
- UPS、数据中心  
UPS、Data Center
- 储能、电力  
Energy Storage、Electric Systems
- 紧急照明、安防  
Emergency Lighting、Security
- 医疗、电子设备  
Medical、Electronic Equipment
- 动力  
Motive Power

## 特征 General Features

- 25°C下，设计浮充寿命可达5年。  
Under 25°C, the designed floating life is up to 5 years.
- 特殊的排气结构和密封技术, 使用安全可靠, 安装灵活, 维护便捷。  
Special exhaust structure and sealing technology, safe and reliable, flexible installation, convenient maintenance.

## 标准 Standards

- 符合IEC 61056, GB/T19639  
Compliance with IEC 61056, GB/T19639
- UL 认证  
UL Certified
- 企业通过了IATF16949,OHSAS 18001, ISO 9001和ISO 14001体系认证  
Manufactured in Leoch@IATF16949, OHSAS 18001, ISO 9001 and ISO 14001 certified production facilities

## 放电特性曲线 Discharge Characteristics

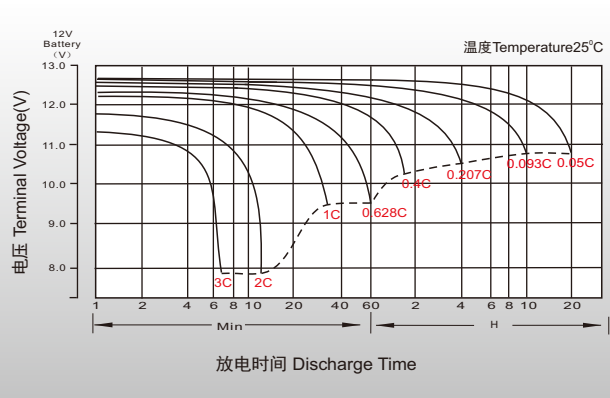

## 浮充特性曲线 Float Charging Characteristics

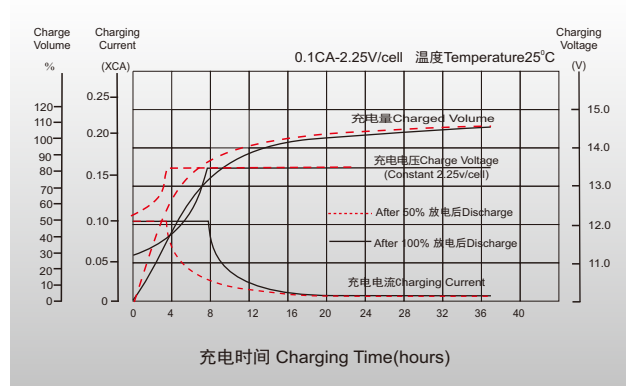

## 温度对容量影响 Temperature Effects in Relation to Battery Capacity

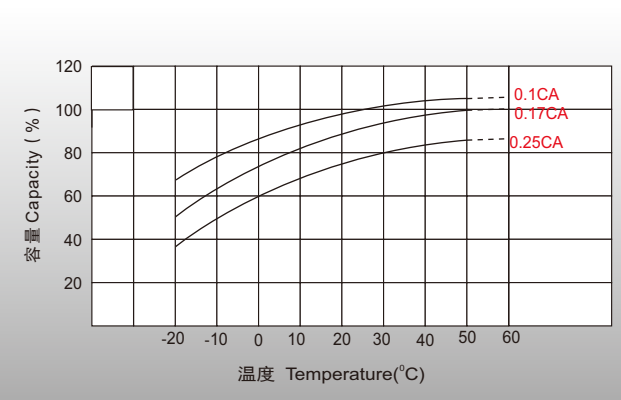

## 温度对浮充寿命影响 Temperature Effects on Long Term Float Life

